

solo[®]

THE BETTER CHOICE. SINCE 1948.



German Quality
German Engineering



INDUSTRIAL SOLUTIONS

Sprayers. VarioFoam. Spreaders. Mist Blowers. eFOG.

When a sprayer is part of your livelihood, it is not just a tool—it is a critical part of your workflow. From daily demands to tough environments, your equipment needs to deliver consistent, dependable performance.

At Solo, we build sprayers that meet that standard and go beyond it. With advanced innovation like eFog 480, built to produce the finest micron droplet from a battery-operated cold fogger, and battery-operated designs engineered for portability and power, our sprayers are setting new benchmarks in precision and performance.

This catalog showcases the latest in spray innovation—built for those who know the difference the right tool makes.

Use your expertise. Trust your judgment. Choose performance that works as hard as you do.

MULTI-PURPOSE

3

Versatile, durable one-hand sprayers, tank sprayers, and spreaders designed for a wide range of industrial applications.

CLEANLINE

4

Engineered for demanding jan san, automotive, and industrial cleaning tasks, designed to handle aggressive chemicals—including alkaline, acidic, alcohol-based, degreasing, and disinfectant solutions—without compromising performance.

VARIOFOAM

8

A standout offering within the CLEANLine range, varioFoam sprayers are specialized for foam-based applications, delivering superior surface coverage and extended contact time for detergents and disinfectants.

CHEMICAL COMPATIBILITY & RECOMMENDATIONS

11

- EPDM vs. FKM Seals
- Recommended Chemical Types
- Application Guidelines for Recommended Chemicals

INDUSTRIAL / HEAVY-DUTY

12

Engineered for demanding applications, our Industrial / Heavy-Duty one-hand, tank and backpack sprayers feature high-performance components designed to withstand rigorous use.

CONSTRUCTION

14

Tank sprayers designed for applying concrete sealers, curing compounds, form release agents, acetone, stain, and etching chemicals.

PEST CONTROL

15

Designed for efficient pesticide applications, mist blowers and sprayers for industrial, agricultural, and commercial pest control operations.

BATTERY-OPERATED

16

One-hand, tank, trolley, and backpack models for various applications that are whisper quiet and free of emissions.

COLD FOGGER

18

Breakthrough backpack battery-operated fogging technology combining portability with the power of 15 µm cold fogging. Built for professionals tackling disease vectors, pests, odors, and mold—without the limitations of thermal systems or cords.

ACCESSORIES AND PARTS KITS

20

ONE-HAND SPRAYER

415



Compact, powerful, and built for convenience, this is your go-to solution for general spraying tasks. Perfect for light industrial use, this sprayer handles a wide range of liquids—from neutral cleaning agents and disinfectants to pest control solutions.

- Chemical-resistant seals for use with neutral chemicals
- Locking trigger reduces operator fatigue
- Automatic pressure relief valve can be manually operated
- Plastic adjustable nozzle adjusts from jet stream to fine mist

Model	415
UPC # 720 343	41500 1
Max. Spray Pressure	30 psi
Capacity	1 l
Pump	Piston
Weight	0.75 lbs
Case Size	12" x 20" x 14.5"
Cubic Feet	2.01
Case Pack	12

TANK SPRAYERS



Tackle a wide range of tasks with confidence using our 1- and 2-gallon Multi-Purpose Sprayers—engineered with many features to benefit the operator. Whether you are disinfecting surfaces in high traffic areas, conducting pest control operations or other general spraying tasks, these durable sprayers deliver reliable, consistent performance every time.

- Chemical-resistant seals for use with harsh chemicals
- Easy-to-fill funnel top
- Large pump handle with a built-in wand retainer
- Durable 24" polywand and shut-off valve assembly with locking trigger
- 45" PVC hose for longer reach
- Automatic pressure relief valve can be manually operated
- Plastic adjustable nozzle adjusts from jet stream to fine mist

Model	211	212
UPC # 720 343	21100 9	21200 6
Max. Spray Pressure	45 psi	
Capacity	1 gal	2 gal
Wand	16"	
Hose	45"	
Pump	Piston	
Weight	3 lbs	4 lbs
Carton Size	17.5" x 7.75" x 7.7 5"	20.75" x 9.25" x 9.25"
Cubic Feet	0.61	1.03
Pallet Quantity	150	80

CHEST-MOUNT SPREADER

421-S



Ideal for professionals who need efficient, controlled material distribution, the chest-mount spreader offers a practical, solution for a variety of industrial and commercial tasks. Whether you are spreading ice melt, oil absorbents or granular chemicals, this versatile tool ensures consistent coverage with minimal effort.

- Fingertip levers control direction and volume
- Large opening allows easy filling and cleaning
- Comfortable cross-shoulder strap
- Fully enclosed gearbox is corrosion resistant
- 20lb. capacity hopper with a cap protects operator from chemicals and dust

Model	421-S
UPC # 720 343	42100 2
Capacity	20lbs
Weight	7 lbs
Carton Size	19.6" x 10.25" x 11"
Cubic Feet	1.28
Pallet Quantity	64

ONE-HAND SPRAYERS

ONE-HAND SPRAYERS



Acidic pH-scale 1-7 (FKM)



Designed specifically for use with acidic cleaning agents, delivering reliable, chemical-resistant performance across a range of demanding industrial and commercial settings. Ideal for applications such as descaling and sanitizing surfaces in food processing areas, commercial kitchens, spas, washrooms, and maintenance zones. In the automotive and auto detailing industries, these sprayers are perfect for cleaning wheels, removing brake dust, and treating acid-resistant metal components with precision.

- Chemical-resistant FKM seals throughout for use with acidic liquids and solutions, including oil or harsh solvents (303-A, 304-A)
- Chemical-resistant EPDM seals throughout for use with alkaline and disinfecting solutions (303-B, 302-B)
- Sealed pump system prevents damage from aggressive chemicals and contributes to long life
- Large pump handle with efficient pump allows full pressurization to 45 psi
- Ergonomically-shaped handle
- Plastic adjustable nozzle adjusts from jet stream to fine mist
- Pump head with slot to insert color-coded content identification card (cards included) (303-A, 304-A, 303-B)

Alkaline pH-scale 7 – 14 (EPDM)



Engineered for safe and effective use with alkaline-based cleaners, degreasers, and disinfectants, CLEANLine One-Hand Sprayers with EPDM seals are engineered for a wide range of industrial, commercial, and automotive cleaning tasks. Chemical-resistant construction ensures compatibility with high-pH solutions commonly used in facility maintenance, sanitation, and surface preparation. In food processing plants and commercial kitchens, they are well-suited for applying degreasers to floors, walls, and equipment. In automotive and auto detailing applications, they deliver precise application of alkaline pre-washes, wheel and tire cleaners, ceramic coatings, and engine bay degreasers—helping professionals break down grease, road grime, and traffic film efficiently. Built for durability and consistent spray control, these sprayers are trusted tools wherever alkaline chemical resistance is required.

Model	303-A	304-A	303-B	302-B
UPC # 720 343	30300 1	30400 8	30301 8	30200 4
Functional Volume	1.25 l / 42 oz	2.0 l / 67 oz	1.25 l / 42 oz	2 l / 67 oz
Max. Spray Pressure	45 psi		45 psi	
Seals Material	FKM		EPDM	
Weight	1.1 lbs	1.3 lbs	1.1 lbs	1.3 lbs
Nozzles	SOLO universal hollow cone nozzle, adjustable		SOLO universal hollow cone nozzle, adjustable	



- 1

Adjustable universal nozzle with significantly improved spray pattern
- 2

Automatic pressure valve can be manually operated for pressure reduction
- 3

Pump head with slot to insert color-coded contents identification card
- 4

Large, highly-efficient and fully-sealed pump unit with sturdy pump handle
- 5

Comfortable trigger with thumb lock for continuous spray function
- 6

High-quality seals made from FKM (A-models) or EPDM (B-models)
- 7

Highly-robust container made of UV-resistant plastic with large filling and cleaning aperture and integrated markings. The base provides stability and prevents overturning.
- 8

Restyled handle: highly-ergonomic operation thanks to comfortable handle design.

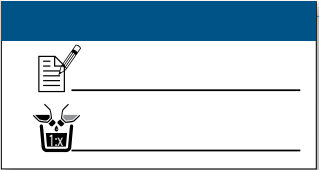



Acidic pH-scale 1-7 (FKM)



CLEANLine 1.5- and 2-gallon sprayers with FKM seals are ideal for large-area applications with acidic solutions. The tough acidic solutions used to clean medical facilities, gyms, washrooms, or plumbing fittings are no match. In automotive and detailing environments, they are well-suited for servicing multiple vehicles, applying cleaners across full fleets, or tackling larger components like undercarriages and wheel wells with ease. Durable construction ensures long-lasting performance in harsh environments, while ergonomic features support frequent, high-volume use.

- Chemical-resistant FKM seals throughout for use with acidic and disinfecting solutions (305-A, 307-A)
- Chemical-resistant EPDM seals throughout for use with alkaline and disinfecting solutions (305-B, 307-B)
- Large piston pump attains full operating pressure as much as 50% faster than competitors' models
- Large 4.5" tank opening for easy filling and cleaning
- Heavy-duty HDPE tank is extremely durable yet light, with visible fill-level markings
- Large pump handle with integrated spray wand holder
- Stable tank base ensures the sprayer will not tip over when filling
- Commercial-quality shut-off valve with locking trigger reduces operator fatigue
- 28" unbreakable wand and shut-off valve assembly for extended reach
- High-quality, chemical-resistant flat fan spray nozzle

Alkaline pH-scale 7 – 14 (EPDM)



CLEANLine 1.5 and 2-gallon sprayers with EPDM seals are built for professional use with alkaline solutions across a wide range of industries, including degreasing in auto-detail, removing grime from industrial equipment in manufacturing, applying powerful detergents in facility maintenance, disinfecting in commercial kitchens for food service, and pre-soak and spot treatment in carpet and rug care. Designed to withstand the harsh effects of high-pH chemicals, CLEANLine EPDM equipped sprayers deliver dependable, high-performance results in even the most demanding environments.

Model	305-A	307-A	305-B	307-B
UPC # 720 343	30500 5	307009	03050 1	03070 9
Functional Volume	1.5 gal	2.0 gal	1.5 gal	2.0 gal
Max. Spray Pressure	45 psi			
Seals Material	FKM		EPDM	
Weight	5.7 lbs	6.2 lbs	5.7 lbs	6.2 lbs
Hose	4.5'			
Wand	20"			
Carry System	shoulder strap			
Nozzles	SOLO flat spray nozzle			



- 1

High-quality nozzles
- 2

Flexible spray wand for the toughest mechanical applications
- 3

Spray wand retainer: two clips for plastic and brass spray wands
- 4

Large aperture to facilitate filling, draining and cleaning
- 5

Automatic pressure relief valve releases excess pressure inside the tank
- 6

Long, broad strap
- 7

Extra-large piston pump—operating pressure achieved after just a few pump strokes
- 8

Sturdy nylon-reinforced hose with commercial-quality shut-off valve
- 9

Transparent spray tank for good visibility of the spray medium level, made from high-density polyethylene



Acidic pH-scale 1-7 (FKM)



Engineered for precise, high-performance application of acidic cleaning solutions in industries where foam coverage is essential, such as food service, automotive detailing, HVAC servicing, commercial cleaning, and manufacturing. Ideal for removing hard water scale, soap scum, and baked-on residue in food service settings, and for applying wheel cleaners, bug removers, and fallout removers in automotive cleaning. HVAC technicians use them to apply coil cleaners and descalers with effective foam coverage. The adjustable varioFOAM system allows users to customize foam density and spray pattern, reducing chemical waste and improving efficiency.

Model	304-FA	333-FA	304-FB
UPC # 720 343	30402 2	33301 5	30403 9
Functional Volume	2 l / 0.53 gal	1.0 gal	2 l / 0.53 gal
Max. Spray Pressure	45 psi		
Seals Material	FKM		EPDM
Weight	1.3 lbs	4.7 lbs	1.3 lbs
Foaming Function	yes		
Hose	-	4.5"	-
Wand	-	20"	-
Carry System	-	shoulder strap	-
Nozzles	SOLO special flat spray nozzle with "varioFOAM" foaming function		

Alkaline pH-scale 7 – 14 (EPDM)



CLEANLine varioFOAM Foaming Sprayers with EPDM seals are designed for professional use with alkaline cleaners, delivering controlled foam in a compact, ergonomic, and chemical-resistant format. Ideal for food service, automotive detailing, HVAC maintenance, sanitation, commercial cleaning, and carpet care, these sprayers handle degreasers, disinfectants, pre-sprays, and traffic lane cleaners with ease. In food service, they apply foaming alkaline degreasers on hoods, appliances, and tile walls. Automotive users apply clinging foaming cleaners for better dwell time. HVAC pros use them for thorough, non-runoff coil cleaning. Carpet professionals benefit from precise, low-moisture spot treatments. The integrated varioFOAM system allows users to adjust foam consistency without nozzle or foam insert changes, cutting waste and boosting efficiency.

- Chemical-resistant FKM seals throughout for use with acidic liquids and solutions (304-FA, 333-FA)
- Chemical-resistant EPDM seals throughout for use with alkaline liquids and solutions (304-FB)
- Sealed-pump system prevents damage from aggressive chemicals and contributes to long life (304-FA, 304-FB)
- Large piston pump reaches full operating pressure as much as 50% faster than competitors' models (333-FA)
- Large 4.5" tank opening for easy filling and cleaning (333-FA)
- Ergonomically-shaped handle (304-FA, 304-FB)
- Stable tank base ensures the sprayer will not tip over when filling (333-FA)
- Commercial-quality shut-off valve with locking trigger reduces operator fatigue (333-FA)
- 28" unbreakable wand and shut-off valve assembly for extended reach (333-FA)
- Adjustable flat fan spray nozzle with varioFoam foaming function allows operator to adjust moisture consistency
- Pump head with slots to insert color-coded content identification card (cards included) (304-FA, 304-FB)

VARIOFOAM



Unique — infinitely variable — perfect foam result

The patented SOLO varioFOAM adjustment system

No interchange of felt inserts, no changing of nozzles, no unnecessary contact with the spray medium.

With the SOLO patented foaming nozzle, varioFOAM, the moisture level can be endlessly adjusted by turning an adjustment wheel even while working. This gives you instant control of any foam agent you use and allows you to extend the soaking time of your cleaning foam.

The wheel is large and comfortable to use, also while wearing gloves. The embossed graduation offers exact adjustment possibilities:

Turning in the direction of "Dry" makes the foam drier and, therefore, more consistent.

Turning in the direction of "Wet" produces gel-like foam with higher moisture content.



BACKPACK SPRAYER

GENERAL RECOMMENDATIONS FOR USE



Acidic pH-scale 1-7 (FKM)



The CLEANLine 315-A Backpack Sprayer is a high-capacity, professional-grade solution designed to tackle large-scale cleaning and chemical application tasks across a variety of industries. With its 4-gallon tank, durable chemical-resistant construction, and ergonomic backpack design, it is built for extended use in demanding environments while minimizing user fatigue. In facility maintenance and sanitation, the 315-A excels at applying disinfectants and floor cleaners in large restrooms, locker rooms, stairwells, and corridors. For food service and food processing facilities, it is ideal for spraying sanitizing agents on walls, floors, prep areas, and behind equipment where reach and coverage are critical. In automotive and transportation, the sprayer is well-suited for washing large vehicle surfaces or applying pre-soaks to fleet vehicles, buses, and heavy machinery. For HVAC and mechanical service, it allows technicians to apply acidic coil cleaners, scale removers, and disinfectants to rooftop units, ductwork, and industrial ventilation systems.

- High-performance piston pump produces pressure up to 60 psi
- Adjustable pressure regulator with four positions: 15, 30, 45, 60 psi
- FKM seals throughout for use with acidic liquids and solutions, including oil or harsh solvents
- Ergonomically-shaped tank with steel base frame
- Extra-large carry handle with wand retailer for easy portability and storage
- Commercial-quality shut-off valve with locking trigger reduces operator fatigue
- 28" unbreakable wand and shut-off valve assembly for extended reach
- Wide, comfortable, padded straps with quick adjustment tabs
- Four-nozzle assortment includes: plastic adjustable, fan spray, hollow cone, and jet stream. TeeJet® compatible.

Model	315-A
UPC # 720 343	03150 8
Functional Volume	4 gal
Max. Spray Pressure	60 psi
Seals Material	FKM
Weight	9.9 lbs
Hose	4.5'
Wand	20"
Carry System	strap & waist belt
Nozzles	Plastic adj., fan spray, hollow cone, jet stream

model group	application	marking	meaning
A	acid	●	suitable
B	alkaline	●	limited suitability
F	foamer	X	not suitable

model group	model	acids ¹	alkalines	alcohols	chloric agents ²	solvents	oily agents
A	303-A / 304-A	●	X	●	●	●	●
A	304-FA / 333-FA	●	X	X	●	X	X
B	302-B / 303-B	X	●	●	●	X	X
B	304-FB	X	●	X	●	X	X
A	305-A / 307-A	●	X	●	●	●	●
B	305-B / 307-B	X	●	●	●	X	X

¹Except formic acid. For acetic acid, B models are suitable. ²Specifically sodium hypochlorite, potassium hypochlorite.

Recommendation for selected cleaning chemicals
These guide values are not suitable for mixtures of various chemicals in cleaners

chemical	recommendation model group	max. concentration
hydrochloric acid	A	20%
sulfuric acid	A	20%
nitric acid	A	20%
amidosulfonic	A	20%
phosphoric acid	A	30%
propanoic acid	A	10%
citric acid	A	20%
hydrogen peroxide	A	10%
acetic acid	B	10%
peracetic acid	A, B	2%
sodium hypochlorite	A	5%
potassium hypochlorite	A	5%
ammoniac	B	10%
sodium hydroxide	B	20%
potassium hydroxide	B	20%
formic acid	X	-
hydrofluoric acid	X	-
acetone	X	-

ONE-HAND SPRAYERS



Our range of One-Hand Sprayers are designed for precision and ease in industrial applications, such as cleaning, degreasing, disinfecting, and chemical treatments. Built with chemical-resistant materials, these sprayers ensure durability and consistent performance. Two models are equipped with extension wands to access hard-to-reach areas safely and efficiently. Ideal for controlled spot application, these compact yet powerful tools are essential for any maintenance, production, or sanitation workflow.

- Chemical-resistantViton®sealstowithstandharshchemicalsforlonglifeanddurability
- Locking trigger reduces operator fatigue
- Unique drift guard for added control and spot treatment
- 9.5" stainless steel wand provides added reach (419)
- Telescoping wand adjusts from 12" to 23" for hard-to-reach spaces (420)

Model	418	418-2L	419	420
UPC # 720 343	41810 1	41802 6	41900 9	42000 5
Max. Spray Pressure	45 psi			
Capacity	1 l		2 l	
Wand	3.5"	3.5"	7"	16" – 23"
Pump	Piston			
Weight	1.2 lbs	1.5 lbs	1.5 lbs	1.55 lbs
Case Size	20.75" x 21.5" x 15.75"		23.75" x 20" x 15.25"	
Case Cubic Feet	4.07		4.19	
Case Pack	16		12	

TANK SPRAYERS



Take on demanding jobs with confidence using our 1- and 2-gallon Heavy-Duty Tank Sprayers—models 211-HD and 212-HD—specially engineered for tough industrial applications. Designed for use in HVAC maintenance, facility cleaning, manufacturing, automotive, and food processing industries. Built with reinforced components for operator-focused features for enhanced comfort and control. Whether you are servicing equipment or maintaining critical workspaces, these sprayers deliver reliable, consistent performance in challenging environments.

- Chemical-resistant Viton® seals to withstand harsh chemicals for long life and durability
- Easy-to-fill funnel top
- Large pump handle with a built-in wand retainer
- Durable 24" polywand and commercial shut-off valve assembly with locking trigger
- 45" PVC hose for longer reach
- No-drip check valve eliminates nozzle drip after pressure is released
- Automatic pressure relief valve can be manually operated
- Plastic adjustable nozzle adjusts from jet stream to fine mist

Model	211-HD	212-HD
UPC # 720 343	21102 3	21202 0
Max. Spray Pressure	45 psi	
Capacity	1 gal	2 gal
Wand	16"	
Hose	45"	
Pump	Piston	
Weight	3 lbs	4 lbs
Carton Size	17.5" x 7.75" x 7.75"	20.75" x 9.25" x 9.25"
Cubic Feet	0.61	1.03
Pallet Quantity	150	80

TANK SPRAYERS



Solo Heavy-Duty Tank Sprayers are built for the toughest jobs and harshest environments. Designed with heavy-duty, chemical-resistant components, these sprayers excel in demanding applications, such as waterproofing, pest control, sanitation, and surface treatment. Ideal for use in construction, agriculture, manufacturing, transportation, facilities maintenance, and industrial cleaning, the Solo Heavy-Duty line delivers consistent, high-performance spraying with rugged durability. Whether you are applying sealants on job sites, controlling pests in commercial settings, or handling corrosive chemicals in industrial operations, these sprayers are engineered to meet the needs of professionals who rely on equipment that works as hard as they do.

- Chemical-resistant Viton® seals throughout withstand harsh chemicals for long service and durability
- Extra-large, heavy-duty pump pressurizes as much as 50% quicker than the competition
- Large 4.5" tank opening for easy filling and cleaning
- Extra-large pump handle with built-in wand retainer for convenient carrying and pumping
- Stable tank base ensures the sprayer will not tip over when filling
- Commercial-quality shut-off valve with locking trigger reduces operator fatigue
- Pressure valve can be manually operated
- 28" unbreakable wand and shut-off valve assembly for extended reach
- 48" nylon-reinforced hose for extended reach
- No-drip check valve eliminates nozzle drip after pressure is released
- Four nozzle assortment: .4 gpm brass, 80° flat fan, plastic adjustable nozzle, jet stream, and hollow cone. TeeJet® compatible.

Model	454-HD	456-HD	458-HD
UPC # 720 343	45402 4	45602 8	45801 5
Max. Spray Pressure	45 psi		
Capacity	1.5 gal	2 gal	3 gal
Wand	20"		
Hose	48"		
Pump	Piston		
Weight	5 lbs	6 lbs	7.9 lbs
Carton Size	22.5" x 8.5" x 8.5"		27" x 9.25" x 9"
Cubic Feet	0.95		1.3
Pallet Quantity	80		60

BACKPACK SPRAYERS



Our Heavy-Duty Backpack Sprayers are built for industrial-grade performance, offering superior durability and comfort for extended use in tough environments. Designed for applications such as degreasing, sanitation, pest control and surface treatment, these sprayers are ideal for use in industries including manufacturing, construction, transportation, facility maintenance, and agriculture when a larger task is required. Featuring high-capacity tanks, chemical-resistant components, and ergonomic harness systems, they provide reliable, high-output spraying for demanding tasks. Whether you are applying harsh chemicals in a factory, disinfecting large commercial areas, or controlling pests around industrial facilities, these backpack sprayers deliver the power and resilience professionals need.

- High-performance piston pump for liquid formulations (425-HD)
- High-performancediaphragmmadeofTivilon®providesoutstandingresistancetoharshchemicals, wettable powders, and bleach solutions (475-B-HD)
- Chemical-resistantViton®sealsthroughoutwithstandharshchemicalsforlongserviceanddurability
- Adjustable pressure regulator with four settings: 15, 30, 45, 60 psi
- Extra-large carry handle with wand retainers for easy portability and storage
- Deluxe shoulder straps and waist belt for operator comfort
- Four-nozzle assortment: brass flat fan, brass adjustable, jet stream, and hollow cone (425-HD) / plastic flat fan, plastic adjustable, jet stream and hollow cone (475-B-HD). TeeJet® compatible.

Model	425-HD	475-B-HD
UPC # 720 343	42577 2	47501 2
Max. Spray Pressure	60 psi	
Capacity	4 gal	
Wand	20"	
Hose	48"	
Pump	Piston	Diaphragm
Weight	11 lbs	
Carton Size	20.25" x 14.75" x 9.25"	
Cubic Feet	1.57	
Pallet Quantity	60	



Accessory
Part # 49211:
A handy durable
wheel set with a
handle for easy
tilting and moving
the sprayer. It can
easily be added to
the sprayer.

Concrete Sprayer

Built for tough construction sites, Solo Concrete Sprayer handles a wide range of demanding applications. It is ideal for applying curing compounds (up to 35% solids), form release agents, bond breakers, sealers, and more. With rugged, chemical-resistant construction, it delivers consistent, high-output performance—perfect for slab finishing, form prep, vertical treatments, and sealing large areas. Reliable and durable for daily use in harsh conditions.



Accessory
Part # 49211:
A handy durable
wheel set with a
handle for easy
tilting and moving
the sprayer. It can
easily be added to
the sprayer.

Acetone Sprayer

The Solo 3-gallon Acetone Sprayer is built for demanding use with acetone, most alcohols, and ammonia-based chemicals. Designed for industries like decorative concrete, flooring, automotive, and construction, it features EPDM seals and heavy-duty components for reliable, high-output performance. Unlike metal canisters, its thick polyethylene tank won't corrode, dent, or break down from harsh chemicals—while remaining lightweight and easy to handle. Ideal for acetone, dyes, stains, sealers, adhesives, degreasers, or cleaning with fast-evaporating solvents, this sprayer delivers the durability and convenience professionals need.

- Chemical-resistant Viton® seals throughout to withstand harsh chemicals for long service and durability (378)
- Chemical-resistant EPDM seals throughout to withstand harsh chemicals for long service and durability (388)
- Extra-large, heavy-duty pump pressurizes as much as 50% quicker than the competition
- High-density polyethylene (HDPE) tank with ultra-violet inhibitors will not dent, crack, or corrode with large 4.5" tank opening
- Stable tank base ensures the sprayer will not tip over when filling
- Commercial-quality shut-off valve with locking trigger reduces operator fatigue
- Built-in inflation valve allows use of a compressor to pressurize the sprayer
- 20" unbreakable wand for extended reach (378) / 20" brass wand for extended reach (388)
- 48" nylon-reinforced hose (378) / 72" acetone-resistant hose (388)
- Six-nozzle assortment: 1° gpm, 110° flat fan for high-solid content curing compounds, plastic adjustable, flat fan, jet stream and hollow cone (378). TeeJet® compatible.
- Heavy-duty brass nozzle assortment: .4 gpm cone, .2 gpm cone, and .5 gpm fan (388). TeeJet® compatible.



Accessory
Part # 49211:
A handy durable
wheel set with a
handle for easy
tilting and moving
the sprayer. It can
easily be added to
the sprayer.

Pressure Water Tank

Solo Pressure Water Tank is a rugged, portable solution for delivering pressurized water on tough job sites. Ideal for cut-off saws, core drills, and dust control, it cools blades and extends tool life. With a quick-connect hose system, durable build, manual pump, and easy-to-fill design, it's perfect for remote locations without a water source. Compact and efficient, it ensures safer, cleaner, and more productive cutting.

- Extra-large, heavy-duty pump pressurizes as much as 50% quicker than the competition
- High-density polyethylene (HDPE) tank with ultra-violet inhibitors will not dent, crack, or corrode
- Large 4.5" tank opening for easy filling and cleaning
- Large pump handle locks-in for easy carrying
- Stable tank base ensures the sprayer will not tip over when filling
- 11.4 ft. nylon-reinforced hose has quick-connect valve for secure attachment

Model	378	388	462	49852
UPC # 720 343	37800 9	388008	00462 5	49852 3
Max. Spray Pressure	45 psi			
Capacity	3 gal	3 gal	2 gal	3 gal
Wand	20"			
Hose	48"	72"	40"	136"
Pump	Piston			
Weight	7.9 lbs		11 lbs	7.3 lbs
Carton Size	27" x 9.25" x 9"		23.5" x 8.25" x 8.25"	27" x 9.25" x 9"
Cubic Feet	1.3		1.57	1.3
Pallet Quantity	60			

Acid Sprayer

The Acid Sprayer is a durable, chemical-resistant tool built to handle corrosive solutions with ease. Ideal for concrete prep, acid staining, etching, masonry cleaning, and equipment descaling, it delivers consistent pressure and reliable performance—perfect for contractors and maintenance pros.

- Chemical resistant Viton® seals withstand harsh chemicals for long service and durability
- Heavy-duty polyethylene tank (HDPE) for dependable use in the most rugged environment
- Translucent tank allows the operator to monitor chemical levels
- Funnel-top design for easy filling
- Acid-resistant, nylon-reinforced hose for added durability
- Adjustable nozzle provides cone to jet stream patterns



Solo Pest Control Operator Sprayer is purpose-built for the commercial operator, offering superior durability, performance, and ease of use in demanding field conditions. At the core of its design is a heavy-duty HDPE (high-density polyethylene) tank that will not dent, crack, or corrode—unlike traditional metal canisters, which are prone to rust, deformation, and chemical degradation over time. This rugged, chemical-resistant construction ensures long-term reliability and reduces maintenance, even with frequent use of harsh pesticides and cleaning agents. Ideal for applying insecticides, herbicides, fungicides, and disinfectants in commercial, industrial, and landscaping environments, the sprayer also features an ergonomic design for operator comfort and multiple nozzles for precise applications. It is a dependable, professional-grade tool designed to keep up with the demands of daily use.

- Chemical-resistant Viton® seals throughout to withstand harsh chemicals for long life and durability
- Extra-large, heavy-duty pump pressurizes as much as 50% quicker than the competition
- Large 4.5" tank opening for easy filling and cleaning
- Extra-large pump handle with built-in wand retainer for convenient carrying and pumping
- Stable tank base ensures the sprayer will not tip over when filling
- Commercial-quality shut-off valve with locking trigger reduces operator fatigue
- Pressure valve can be manually operated
- 28" brass wand with ergonomic shut-off valve assembly for extended reach
- Extra-long 72" commercial pesticide-compatible hose for extended reach and durability
- No-drip check valve eliminates nozzle drip after pressure is released
- Three-nozzle assortment: .4 gpm brass 80° flat fan, brass adjustable, and jet stream. TeeJet® compatible.

Model	454-PCO
UPC # 720 343	45403 1
Max. spray pressure	45 psi
Capacity	1.5 gal
Wand	20"
Hose	72"
Pump	Piston
Weight	5 lbs
Carton Size	22.5" x 9" x 9"
Cubic Feet	1.05
Pallet Quantity	80

BACKPACK MIST BLOWER

466-MASTER



Solo Backpack Mist Blower is a high-powered, professional-grade solution designed for large-scale pest and parasite control in industrial and agricultural settings. With a robust 66.5 cc 2-stroke engine, this mist blower delivers a fine, even spray, which is ideal for mosquito and insect control, disinfecting, deodorizing, applying herbicides, fungicides, and antiparasitic treatments. Commonly used in commercial pest control, public health operations, and livestock management, it is particularly effective for parasite control in animal herds—helping to reduce infestations and support animal health. The ergonomic backpack design ensures comfort during extended use, and the adjustable nozzle with variable flow control provides targeted application across a variety of terrains. Built for durability and maximum efficiency, this mist blower is essential for professionals operating in demanding environments.

- 66.5 cc Solo engine generates a fan air volume of max. 824 cfm
- Aluminum crankcase and high-quality engine components for increased power output
- Engine performance converts to higher misting performance
- Fuel efficiency and lower emissions with modern engine technology and catalytic converter
- Long reach wide angle nozzle
- Effective vibration dampening
- Single multi-functioning operating handle
- Ergonomically-shaped and padded tank frame with wide, comfortable, padded straps and large padded hip belt for superior operator comfort

Model	466-MASTER
UPC # 720 343	00466 3
Bat. / Engine	2-cycle
Displacement	66.5 cc
Power	2.1 kW / 2.9 hp
Capacity	3.7 gal.
Weight	22 lbs
Carton Size	12.5" x 28.75" x 16.75"
Cubic Feet	3.5
Pallet Quantity	10



ULV nozzle with metering device
Part # 49480



Twin nozzle
Part # 4900137



Extension wand
Part # 4900333



Liquid booster pump
Part # 4400117

Our line of Battery-Operated Sprayers—including one-hand, tank, and trolley models—is built for multi-purpose industrial performance across a wide range of professional applications. These sprayers are completely pump-free, delivering consistent pressure at the push of a button, which significantly reduces operator fatigue and increases efficiency on the job. Whether you are in automotive detailing, HVAC maintenance, pest control, sanitation, agriculture, or general facility upkeep, there is a sprayer in this lineup sized to match your needs. In auto detailing, they provide precise and even application of soaps, degreasers, and coatings—perfect for both interior and exterior use. In HVAC and facility maintenance, they make it easy to apply coil cleaners, disinfectants, and degreasers with minimal effort. The compact one-hand models are ideal for tight spaces and spot treatments, the tank sprayer balances portability with capacity for mid-sized tasks, and the trolley sprayer offers maximum volume with smooth mobility, allowing operators to cover large areas without heavy lifting. Built with chemical-resistant components and designed for daily use in tough environments, these Battery-Powered Sprayers offer unmatched versatility, ease of use, and professional-grade performance across industries.

ONE-HAND SPRAYERS



- Chemical-resistant Viton® seals withstand harsh chemicals compatible with 1-7 pH (260)
- Chemical-resistant EPDM seals withstand alkaline chemicals compatible with 7-14 pH (360-B)
- Flexible pick-up tube ensures complete emptying of the tank and allows spraying at any angle
- Ergonomic design with comfortable operating handle and smooth one-button operation
- Integrated lithium-ion battery for up to 60 min of continuous operation time
- Easy charging at every USB port (charging cable included)
- Adjustable nozzle provides mist to jet stream pattern

Model Part no.	260	360-B
UPC # 720 343	26000 7	36000 4
Battery, Voltage / Capacity	3,7 V / 1,4 Ah	
Functional Volume	1 L	
Nozzle	Adjustable nozzle	
Suction Hose	Flexible, spray from any angle	
Operation Time Max.	approx. 60 min.	
Charging Time	approx. 90 - 120 min.	
Weight	1 lb	
Included	USB charging cable	

TANK SPRAYER



- Chemical-resistant seals for use with neutral chemicals
- Transport handle and strap provides easy transport
- Removable 11.1 V lithium-ion battery with up to 2.75-hour continuous operating time (separate charging station included)
- 1.6-gallon translucent formula tank with a stable tank base.
- Extra-long 6.5' coil hose makes it convenient to spray even when the sprayer is on the ground
- 28" unbreakable wand and shut-off valve assembly for extended reach
- Adjustable nozzle provides mist to jet stream pattern

Model Part no.	206-EAZY
UPC # 720 343	20600 5
Max. Spray Pressure	37.5 psi
Capacity	1.6 gal
Wand	20"
Hose	6.5' coil
Bat. / Engine	11.1 V
Power	2.5 Ah
Weight	4.85 lbs
Carton Size	13.75" x 16.75" x 7.5"
Cubic Feet	1.0
Pallet Quantity	72

216 EAZY-Roll



- Chemical-resistant seals for use with neutral chemicals
- Large 4.75" opening with inlet filter
- Large oversized and well-supported 7" wheels that move quietly and easily pass obstacles (total width only 13.8")
- Ergonomic and robust telescopic aluminum handle that can be extended and locked with a push button
- Removable battery with 2.8-hour continuous operating time (separate charging station included)
- Spiral hose provides easy and extended movement and coils neatly when not in use
- Adjustable nozzle provides mist to jet stream pattern

TROLLEY SPRAYER

Model Part no.	216 EAZY-Roll
UPC # 720 343	21603 5
Max. Spray Pressure	37.5 psi
Capacity	4 gal
Wand	20"
Hose	6.5' coil
Bat. / Engine	11.1 V
Power	2.5 Ah
Weight	10.8 lbs
Carton Size	11.5" x 23" x 12.5"
Cubic Feet	1.92
Pallet Quantity	48

BACKPACK SPRAYERS



Our Battery-Powered Backpack Sprayers, available in 3-gallon and 4-gallon models, are built for industrial and maintenance tasks for large areas. Common applications include cleaning equipment and surfaces in manufacturing plants, sanitizing high-traffic areas in warehouses and transit hubs, and maintaining stadiums, restrooms, and parking structures. The 4-gallon model offers extended coverage for larger spaces, while the 3-gallon version is suited for more detailed work. Both provide consistent spray performance, long battery life, and ergonomic comfort for demanding industrial use.

- Chemical-resistant seals for use with neutral chemicals
- 11.1 V lithium-ion battery with 2.5 hour running time.
- Large 4.75" opening with removable filter basket
- 3-gallon translucent tank (411)
- 4-gallon translucent tank (441)
- Integrated carry handle for easy transport
- Stable tank base ensures the sprayer will not tip over when filling
- Commercial-quality shut-off valve with locking trigger reduces operator fatigue
- 28" unbreakable wand and shut-off valve assembly for extended reach

Model Part no.	411	441
UPC # 720343	41101 0	42400 3
Spray Pressure	37.5 psi	
Capacity	3 gal	4 gal
Wand	20"	
Hose	48"	
Bat. / Engine	11.1 V	
Power	2.5 Ah	
Weight	9.5 lbs	10 lbs
Carton Size	20.5" x 16" x 10"	24" x 16" x 10"
Cubic Feet	1.9	2.23
Pallet Quantity	48	44

SEMI-PRO BACKPACK SPRAYER



417-Li

The Semi-Pro 4.5-gallon Battery-Operated Sprayer is engineered for reliability, capacity, and performance—making it an ideal choice for municipalities, public works departments, and industrial service providers. Built for routine use in demanding environments, this sprayer is equipped to safely handle a wide range of solutions, including disinfectants, degreasers, odor control agents, and general-purpose cleaners. Its large 4.5-gallon tank and extended battery runtime enable efficient coverage of expansive areas such as transit stations, correctional facilities, schools, maintenance yards, and other critical infrastructure. Designed for operator comfort, it features ergonomic support with padded straps, consistent spray pressure, and easy-access controls. Durable and efficient, it is a smart choice for high-volume sanitation and maintenance tasks.

- 11.1 V lithium-ion battery with 2.5 hour running time.
- Large 4.75" opening with removable filter basket
- 4.5-gallon translucent tank
- Pressure gauge allows easy monitoring of pressure level
- Electronic two-step switch: Low: 36 psi / High: 62 psi
- Integrated carry handle for easy transport
- Stable tank base ensures the sprayer will not tip over when filling
- Commercial-quality shut-off valve with locking trigger reduces operator fatigue
- Equipped with comfortable padded backpack support frame with wide padded shoulder straps
- 28" unbreakable wand and shut-off valve assembly for extended reach

Model Part no.	417-Li
UPC # 720343	00417 5
Spray Pressure	36 psi / 62 psi
Capacity	4.5 gal
Wand	20"
Hose	60"
Bat. / Engine	11.1 V
Power	7.2 Ah
Weight	17 lbs
Carton Size	25" x 17.5" x 11.5"
Cubic Feet	2.9
Pallet Quantity	30

eFOG 480 – EMISSION-FREE FOGGING – BATTERY-POWERED BACKPACK COLD FOGGER

eFOG 480 – FOGGING IN THE μ – RANGE, CORDLESS AND EMISSION-FREE



New Solo Backpack Battery-Powered Cold Fogger, the eFOG 480, sets a global benchmark for professional vector control. It can be used indoors for disinfecting surfaces.

It is quiet, lightweight, cordless, and emission-free: portable fogging has never been easier or more efficient and effective. The combination of a backpack base with a connected handheld applicator creates a unique fog with extremely small, adjustable droplet sizes.

Powered by an 18 V lithium-ion battery, the high-pressure pump generates a highly efficient chemical fog through the nozzle, which can be directed using an adjustable blower. A laser aiming aid is added for targeting assistance.

- Application:
- Disease Prevention and Public Health
 - Vector Control and Pest Management
 - Disinfection and Sanitation
 - Odor Elimination
 - Mold and Mildew Remediation
 - Agriculture and Horticulture

What makes the eFog 480 so unique?

Innovation

The eFog 480 achieves droplet size previously only possible by heavy noisy thermal or cold foggers with combustion engines. The lightweight Solo cold fogger operates quietly and emission-free. It can be operated in noise-sensitive areas.

High-Pressure Pump

This machine has a specially developed high-pressure electric pump, generating an operating pressure of up to 1885 psi. The result is an unparalleled level of fog generation for cold foggers. 75% of the droplets have a diameter of less than 15 μm.

Comfort Meets Practicality

The droplet size can be adjusted via the electronic control panel. The integrated laser aiming aid is helpful in targeting the fog under unfavorable environmental conditions. All essential device information can be found on the control panel: blower output, pressure range, battery status, filtration and service notifications.

Safety First

All sensitive electronic components and battery are hermetically sealed from the environment. The chemical liquid is filtered multiple times from the filter opening to the nozzle. All filters can be replaced quickly. System ventilation is quick and easy. The control panel displays important device information, such as the need for maintenance.

Solo Product Details

- Ergonomically-designed unit with a 1.6-gallon tank
- Efficient high-pressure pump with removable 18V/5Ah battery provides 3.5 hours of continuous operating time
- 1885 psi
- Droplet sizes MVD¹ 23-48 μm, adjustable
- Blower airflow 280 m³/h at 16 m/s (165 cfm at 52 fps)
- Exceptionally comfortable backpack carry system with hip belt
- Compact: handheld unit with blower and keypad
- Adjustable fan speed
- Laser aiming assistance
- Additional nozzle 0.3 (part #15792) for different droplet size can be purchased separately
- Built-in compartment for an extra battery is integrated in the backpack unit for carrying a second battery
- Very quiet, emissions-free, and cordless

¹Mean volumetric diameter. 50% of the total liquid volume is smaller than the stated values, 50% is larger.

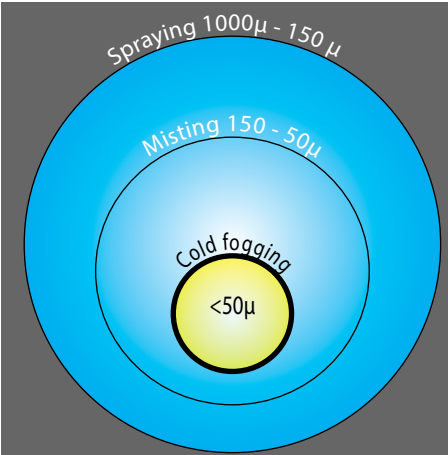

SOLO eFog 480 output data with water 20°C

nozzle	pressure setting	output flow				droplet size in μm			
		ml/min	L/h	oz/min	US-gal./h	without blower	with blower		
0.1	1	19	1,14	0,642	0,301	47,6	14	35,5	12
	2	27,4	1,64	0,927	0,434	42	13	28,8	11
	3	33,7	2,02	1,140	0,534	39,1	11	26,1	11
	4	38,5	2,31	1,302	0,610	38,2	10	23,5	10
0.2	1	41,2	2,47	1,393	0,653	53,7	16	41,6	15
	2	60,8	3,65	2,056	0,964	48,6	15	35,4	14
	3	74,5	4,47	2,519	1,181	45,2	13	32,2	13
	4	86,3	5,18	2,918	1,368	44,9	12	30,2	12



All functions fully integrated into the hand controller for quick, comfortable & easy adjustments while spraying.



Hand unit with control panel and integrated blower fan



Ergonomic shape, practical carry handle, and large opening for easy filling and cleaning



Model	SOLO eFOG 480 Battery-Powered Cold Fogger
UPC # 720343	48000 9
Tank	6 l (1.6 US gal.)
Pump	High-pressure pump max. 130 bar (1885 psi)
Battery	18 V Li-Ion battery; 5 Ah
Charger	4 A, 100-240 V, 50/60 Hz
Nozzles	0,1 mm and 0,2 mm
Operating Time per Battery	3.5 h pump only (pressure level 4, 130 bar); 1.6 h pump (pressure level 4, 130 bar) + blower max. power; each with nozzle 0.1
Charging Time	1,5 h
Droplet Sizes MVD	23-48 μm, adjustable
Blower airflow	280 m³/h at 16 m/s (165 cfm at 52 fps)
Droplet Sizes MVD ¹ (DV50), Water-Based	adjustable by pressure and blower levels: Nozzle 0.1: 23 - 48 μm Nozzle 0.2: 30 - 54 μm
Droplet Szes MND ² , Water-Based	Nozzle 0.1, at max. pressure: 10 μm
Output Rate Pressure-Dependent	Nozzle 0.1: 1.14 - 2.31 L/h (0.301 - 0.610 USgal/h) Nozzle 0.2: 2.47 - 5.18 L/h (0.653 - 1.368 USgal/h)
Weight	Backpack unit 7.3 kg (16.1 lbs) with battery; Hand unit 1.3 kg (2.9 lbs)

¹ Mean volumetric diameter. 50% of the total liquid volume is smaller than the stated values, 50% is larger.
² Mean numeric diameter. 50% of the droplet count is smaller, 50% larger than the stated value.

ACCESSORIES AND PARTS KITS

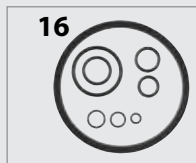
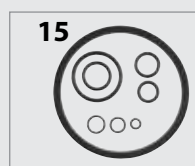
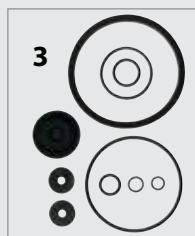
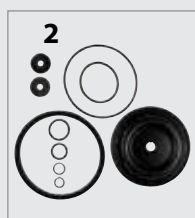
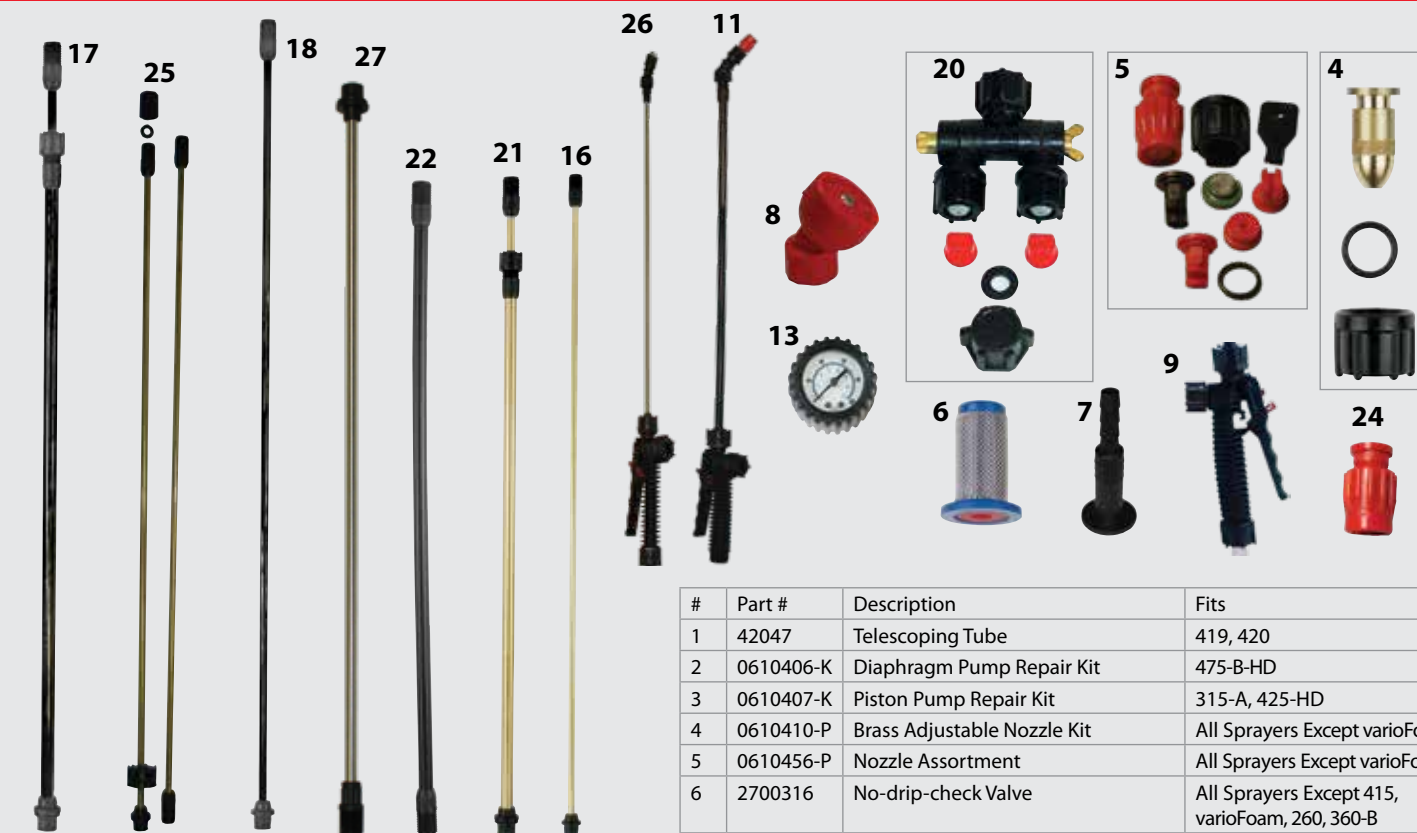

#	Part #	Description	Fits
1	42047	Telescoping Tube	419, 420
2	0610406-K	Diaphragm Pump Repair Kit	475-B-HD
3	0610407-K	Piston Pump Repair Kit	315-A, 425-HD
4	0610410-P	Brass Adjustable Nozzle Kit	All Sprayers Except varioFoam
5	0610456-P	Nozzle Assortment	All Sprayers Except varioFoam
6	2700316	No-drip-check Valve	All Sprayers Except 415, varioFoam, 260, 360-B
7	4074654	1/4" and 3/8" Hose Barb	For Shut-Off Valve 4800170
8	4074666-P	Multi-pattern "Speed Tip" Nozzle	All Sprayers Except One-Hand, varioFoam
9	4800170-P	Shut-Off Valve	All Tank and Backpack Sprayers
10	49211	Wheel Set & Pull Handle Accessory	378, 388, 458-HD, 49852
11	4900170N	28" Universal Wand Assembly	All Tank and Backpack Sprayers Except varioFoam
12	4900299	4-Nozzle Spray Boom	All Sprayers Except One-Hand and varioFoam
13	4900622	Pressure Gauge w/ Adapter	All Tank and Backpack Sprayers
14	4900406-K	Pump Repair Kit, EPDM	305-B, 307-B, 388
15	4900407-K	Pump Repair Kit, Viton®/ FKM	305-A, 307-A, 333-FA, 454-HD, 456-HD, 458-HD, 378
16	4900421	20" Brass Wand	All Tank and Backpack Sprayers Except varioFoam
17	4900445	48"-92" Telescoping Carbon Fiber Wand	All Tank and Backpack Sprayers Except varioFoam
18	4900449	48" Carbon Fiber Wand	All Tank and Backpack Sprayers Except varioFoam
19	4300343	Deluxe Shoulder Saver Harness	315-A, 425-HD, 475-B-HD
20	4900477	Double Spray Nozzle	All Tank and Backpack Sprayers
21	4900478	20"-40" Brass Telescoping Wand	All Tank and Backpack Sprayers Except varioFoam
22	4900513	20" Extension Tube	All Tank and Backpack Sprayers Except varioFoam
23	4900514	2-Nozzle Spray Boom	All Sprayers Except One-Hand, varioFoam
24	4900527	Plastic Adjustable Nozzle	All Sprayers Except VarioFoam
25	4900528	60" Brass Wand	All Tank and Backpack Sprayers Except varioFoam
26	4900645-P	21" Stainless Steel Wand	All Tank and Backpack Sprayers Except varioFoam
27	4900647-P	29" Universal Stainless Wand Assembly	All Tank and Backpack Sprayers Except varioFoam

solo

201 Enterprise Drive
Newport News, VA 23603
www.us.solo.global

Phone: (757) 245-4228
Fax: (757) 245-0800

Order Desk Phone:
(757) 245-5531

USLI102025